

17 Does it fit?

Attachments

- 1 What's this equipment for? What's it testing?
Locate these things in the picture (a-j).

- | | |
|---------------|------------|
| 1 golf ball | 6 air bag |
| 2 golf driver | 7 turbine |
| 3 wheel | 8 bell |
| 4 rope | 9 gauge |
| 5 string | 10 plunger |

What other parts of the equipment can you name?

- 2 How does it work? What's the first action?
Use these verbs to describe what happens.

cuts indicates rings hits ~~pulls~~
spins escapes pushes turns

- 3 Use each verb once to complete this description.

When everyone is ready, the first technician ...pulls¹ the string and² the bell. Then the second technician³ the rope and the wheel⁴ round. The golf driver⁵ the ball at the plunger and⁶ the plunger into the bag of air. Some air⁷ and⁸ the turbine. The gauge⁹ the estimated distance of the shot.

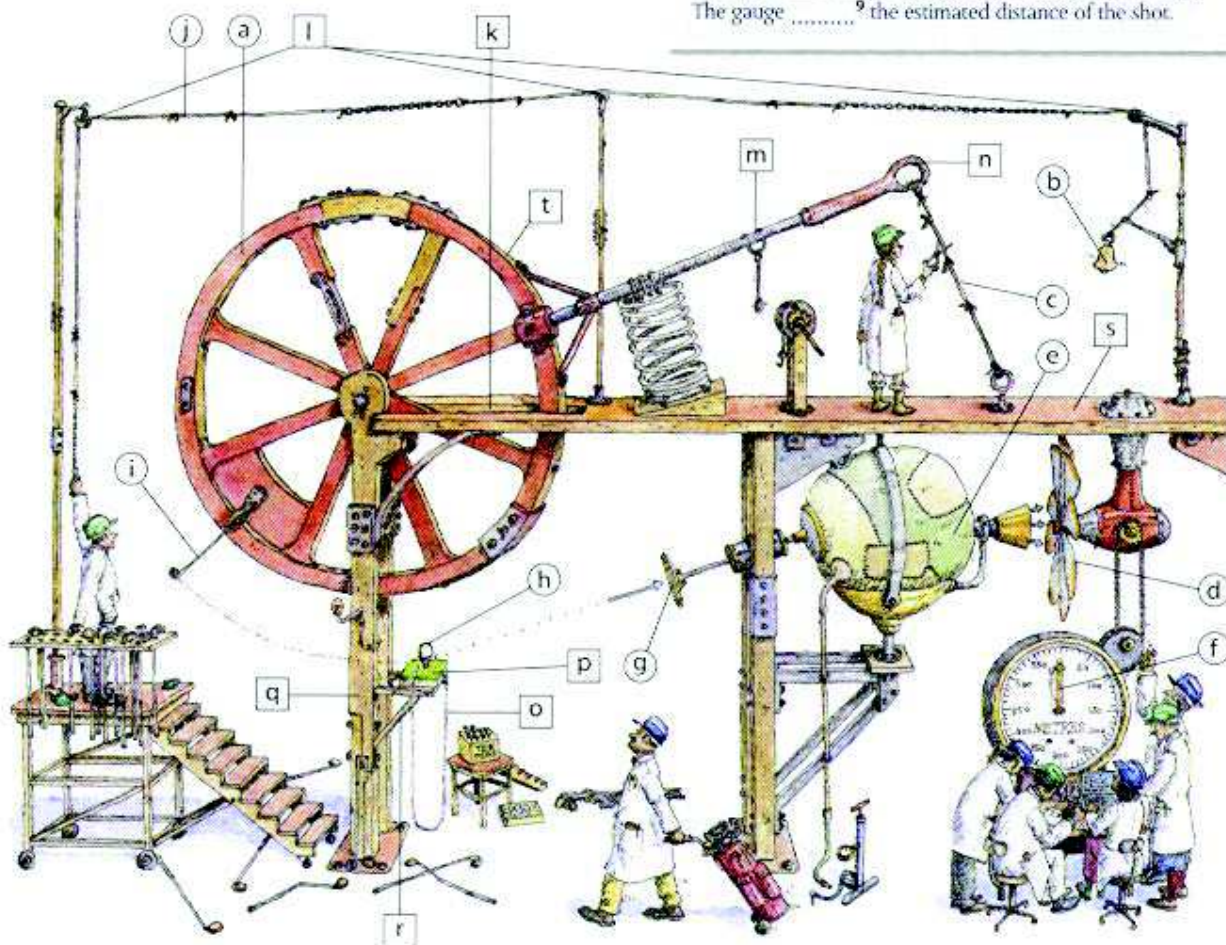

- 4 Read this description of the equipment.
Locate the items in bold in the picture (k-t).

The wheel rests on a vertical wooden **support** attached to a horizontal **platform**. There's a **slot** in the centre of the platform at one end, so the wheel can turn freely. A cylindrical wooden **beam** is bolted onto the **rim** of the wheel at right angles. The beam has a large **ring** at one end, which is tied to another ring on the platform. A piece of string runs over three **pulleys** above the machine. When someone pulls it, it rings a small bell. The golf ball is placed on a **shelf** supported by a wooden **bracket**. The ball is attached to the shelf by a thin metal **chain**.

- 5 Match these phrases to the best diagram.

- | | |
|----------------------------|-------------------------|
| 1 is supported | 6 is pivoted |
| 2 is attached / stuck | 7 is hinged |
| 3 is secured with brackets | 8 is linked / connected |
| 4 is bolted | 9 is housed |
| 5 is tied | 10 is clamped |

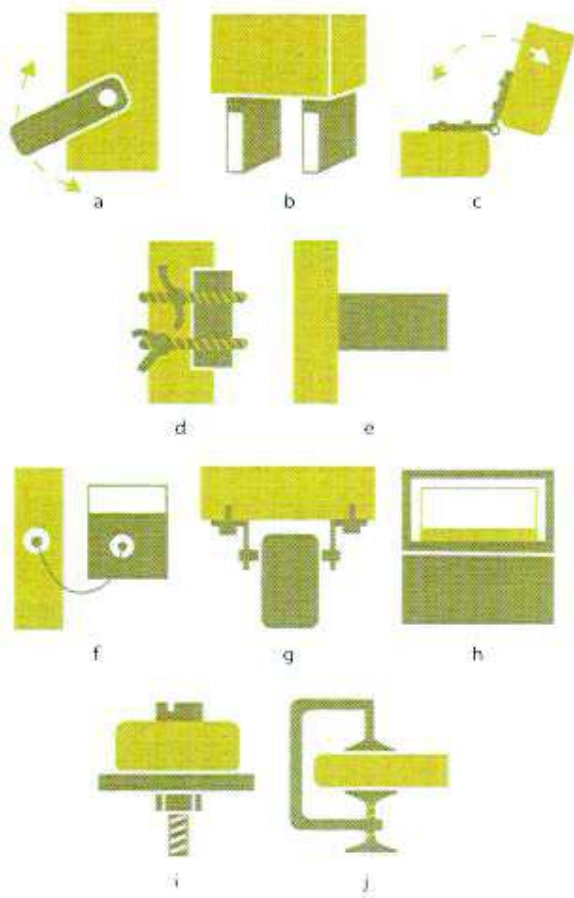

- 6 Draw three more diagrams for these phrases.

- 1 is suspended
- 2 is hooked
- 3 is chained

- 7 Look around the room and find some joints and places where things are fastened or connected. Describe the connections.

Example

The legs are bolted on to the frame of the table.

- 8 Work with a partner.

A - look at the information below.

B - look at file 32 on page 114.

A

You and your partner have the same picture, but they are incomplete.

- 1 Ask your partner how these things are connected, linked, etc., and draw the attachments on your picture.
 - 1 the television
 - 2 the dog
 - 3 the clock
 - 4 the torch
 - 5 the toothbrush and toothpaste
- 2 Tell your partner how other things are attached, supported, etc. so they can draw the attachments on their picture.



Locating parts

- 1 Listen to someone ordering parts for this vacuum pump. Which parts does he want?

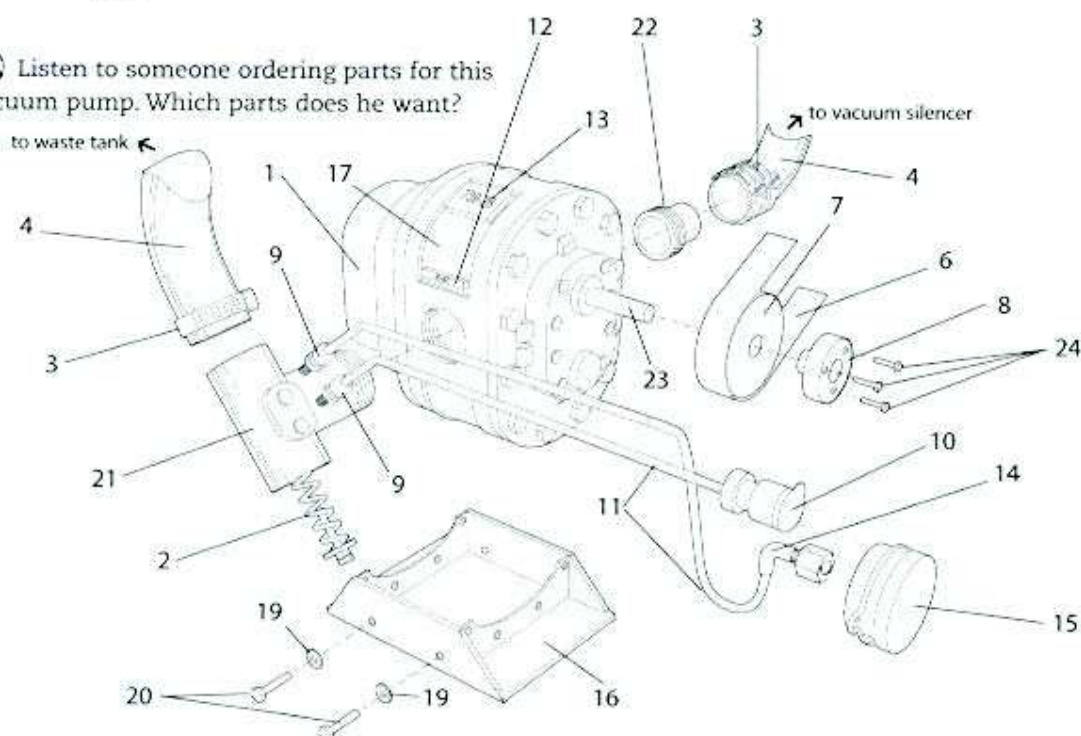

- 2 Listen again and identify these parts. Write the part numbers in the table.

Part	Part number
a plate	
b serial number	
c model number	
d shaft	
e pulley	
f belt	
g flanged hub	
h hub screw	

- 3 Listen again and complete these sentences.

- Is it on the of the pump?
- No, it's on the near the
- The model number is that, near the of the plate somewhere.
- Well, the pump, there's a rod that sticks out.
- No, but the pulley there's another circular part.

- 4 Compare these locations:

The shaft is **on the front of** the pump.

The pulley is **in front of** the pump.

Which phrase do we use when things aren't touching?

Describe where things are in relation to the television. Use phrases from the list.

behind	on the front of	under
in front of	on the bottom of	above
on the top of	on the back of	

The remote control is **in front of** the television.

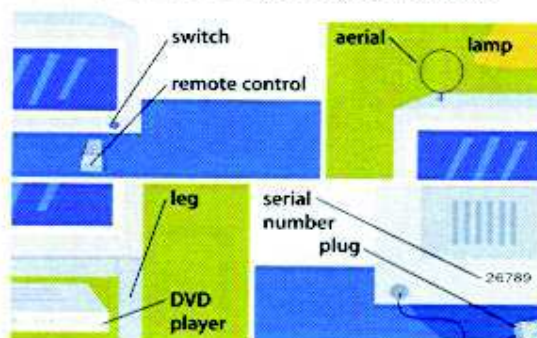

- 5 Read this description of the pump. Identify more parts and write their part numbers in the table.

The valve assembly screws into the left hand side of the pump. It is connected to the waste tank by a hose. A circular clamp fits round the hose and holds it securely. The spring relief valve sticks out of the bottom of the valve assembly.

Two connectors fit into two holes on the front of the valve assembly. They are attached to two long tubes. The top tube leads to the elbow joint and the vacuum gauge. The bottom tube leads to the lubricating cup.

A large outlet nipple screws into the right hand side of the pump. It's connected to the vacuum silencer by a hose. Two clamps fit round the hose and hold it securely.

The pump sits on top of the mount. There are two holes in the left hand side of the mount. Two bolts pass through the holes and fasten the pump to the mount. The bolts pass through two washers.

Part	Part number
a valve assembly	21
b hose	
c clamp	
d spring relief valve	
e connector	
f tube	
g elbow joint	
h vacuum gauge	
i lubricating cup	
j outlet nipple	
k mount	
l bolt	
m washer	

- 6 Look at the diagram in 1 and use the phrases in the list to complete these sentences.

is connected to screws into fit into
sticks out of leads to
passes through fits round

Example

One of the hoses is connected to the waste tank.

- The other hose the vacuum silencer.
- The valve assembly the pump.
- The shaft the pump.
- The shaft the pulley.
- The belt the pulley.
- The connectors the holes.

- 7 Work with a partner.

A – look at the information below.

B – look at file 35 on page 115.

A

This diagram shows an ice-making machine, but five of the part names are missing. Your partner has the same diagram. Find out the names of the missing parts and write them down.

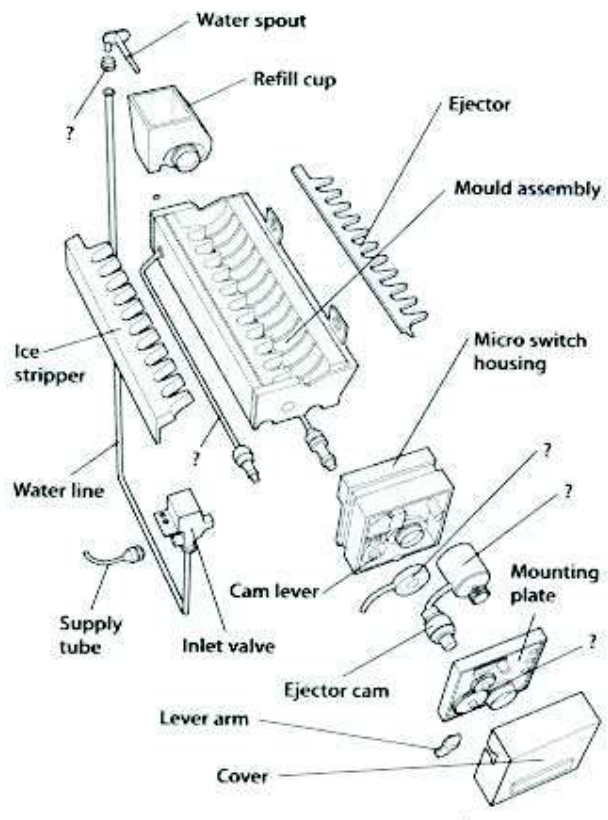

Does it fit?